

e-Science Hub

NeSC e-Science Hub at the University of Glasgow

www.nesc.ac.uk/hub/

Overview

The e-Science Hub at the University of Glasgow is the physical location of the NeSC in Glasgow.



The Hub acts as a focal point for e-Science related activities at Glasgow.

Associated Departments

The Department of Computing Science and Department of Physics & Astronomy were involved in the initial proposal for NeSC and continue to work closely.

The e-Science Hub has been involved directly with other groups at Glasgow including the Bioinformatics Research Centre, the department of Electronics and Electrical Engineering and the centre for BioStatistics. Outreach and collaborations with other centres at Glasgow University is on-going.

Projects

Current projects include:

- BRIDGES

www.brc.dcs.gla.ac.uk/projects/bridges

- eDIKT

www.edikt.org

- PGPGrid

<http://www.epcc.ed.ac.uk/pgpgrid/>

- ScotGrid

www.scotgrid.ac.uk

- GridPP

www.gridpp.ac.uk

Facilities

The e-Science Hub has been allocated 230.5sq metres in the Kelvin Building of Glasgow University including four offices, one large laboratory, a next generation multimedia conferencing facility (Access Grid) and connecting operator/printer room.



A map of the space allocated to the Hub in the Kelvin building is shown in yellow below.

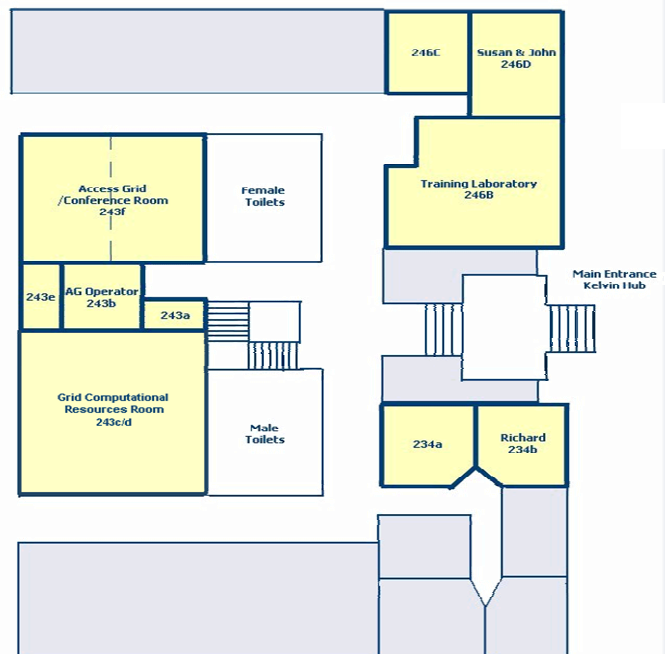

'Delivering e-science'

Resources

The primary computational resource made available through the e-Science Hub is the ScotGrid Infrastructure.



ScotGrid is a 190 processor cluster consisting of IBM servers (x330, x335, X370, Blade Centers); 5TB FASTT500 Storage servers 5TB); and several Dell machines. These represent an on-going consolidation of the computational resources at Glasgow University. In terms of local community, this resource is primarily used by particle physicists and bioinformaticians, however other groups are encouraged to use/contribute to this resource.

Level 2 Grid Resources

We currently have one machine - Neptune taking part in the Level 2 Grid project. Neptune is a 4 CPU Sun Enterprise 450 with 2GB of RAM running Solaris 7 and 166GB of disk space. In May 2003 we became the first UK e-Science Centre to run ETF integration tests across every site of the Level 2 Grid. We therefore have nearly 100% access to the L2G resources at this time. We hope to extend our project capabilities by offering Condor and Sun GridEngine job managers to the other L2G sites in the very near future.

Training Laboratory

A training laboratory has been established which will provide courses on e-Science related technologies and techniques.



Access Grid Conference Facility

An Access Grid is a multimedia conference facility that can be used to run real time multi site meetings. The current set up in Glasgow includes 3 IBM servers, one for audio data, one for the display, and one for video. The facility is used regularly to hold meetings between Edinburgh and Glasgow NeSC staff.

The Access Grid is available to book for e-science related meetings or conferences, to make a booking please email susan@nesc.ac.uk.

Contact Information

e-Science Hub

Kelvin Building
University of Glasgow
Glasgow G12 8QQ

Technical Director

Dr Richard Sinnott



+44 (0)141 330 8606
ros@dcs.gla.ac.uk

Access Grid & Web Enquiries

Miss Susan Andrews



+44 (0)141 330 8648
andrewsm@dcs.gla.ac.uk

Level 2 Grid Enquiries

Dr John Watt



+44 (0)141 330 8647
jwatt@dcs.gla.ac.uk